

MATERIALS

HOUSING: HI-TEMP. PLASTIC (UL 94V-0), BLACK
 SHELL: STAINLESS STEEL
 PAD: STAINLESS STEEL, GOLD PLATING
 TERMINAL: COPPER ALLOY, GOLD PLATED ON CONTACT AREA
 TIN PLATING ON SOLDER TAIL

SPECIFICATION

CURRENT RATING: 0.5 AMP MAX
 DIELECTRIC WITHSTANDING: 500V AC FOR ONE MINUTE
 CONTACT RESISTANCE: 60m OHMS MAX
 INSULATION RESISTANCE: 1000M OHMS MIN AT DC 500V
 OPERATION TEMPERATURE: -25°C~+85°C

PART NUMBER:

MMCKD - 0 8 * T - 1 2 1

SERIES ————
 NO. OF POS. ————
 T ———— TAPE REEL PACKAGE
 1 2 1 ———— TIN PLATING ON SOLDER TAIL

CONTACT PLATED OPTION

- 1: GOLD FLASH
- 3: 3u" GOLD
- 5: 5u" GOLD
- 6: 10u" GOLD
- 7: 15u" GOLD
- 9: 30u" GOLD

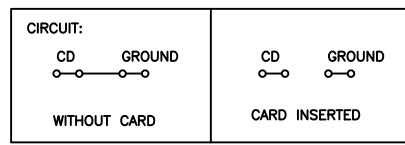
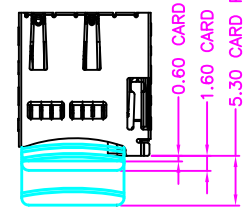
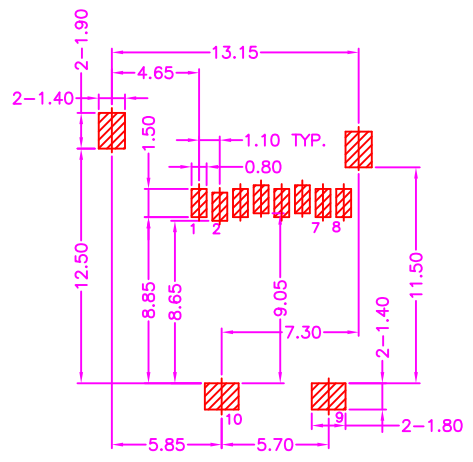
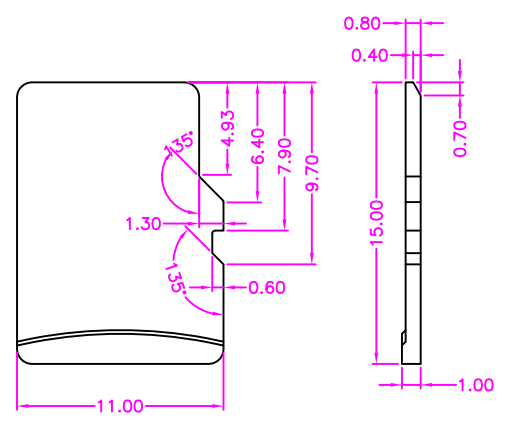

Pin No.	MICRO SD
PIN1	DAT2 1P
PIN2	CD/DAT3 2P
PIN3	CMD 3P
PIN4	VDD 4P
PIN5	CLK 5P
PIN6	VSS 6P
PIN7	DAT0 7P
PIN8	DAT1 8P
PIN9	CARD DETECT
PIN10	



TOLERANCES
 X.±0.40 .XX±0.20
 .X±0.30 .XXX±0.10

REV.	A	DRAWN BY	Zhong 2017/12/5	TITLE	MICRO SD CARD, 8PIN, PCB MOUNT, SMT, METAL SHIELD, PUSH PUSH TYPE FEMALE, H=1.85mm
		APPROVED BY	Lion 2017/12/5	DRAW NO.	MMCKD-001

UNIT	MM	Sheet	1/1
------	----	-------	-----