

P.C.B. LAYOUT
TOP VIEW±0.05

PART NUMBER:
BUSTA - 0 5 * - 1 2 2

SERIES — NO. OF POS. — CONTACT PLATED OPTION
TAPE REEL PACKAGE

1: GOLD FLASH
3: 3u" GOLD
5: 5u" GOLD
7: 15u" GOLD
9: 30u" GOLD

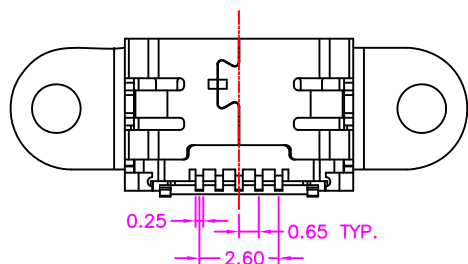
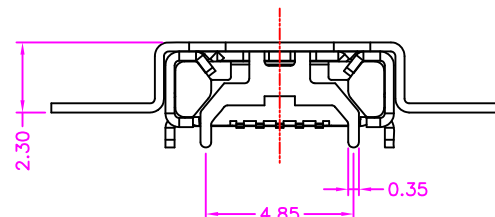
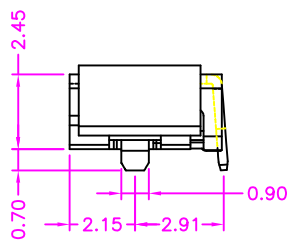
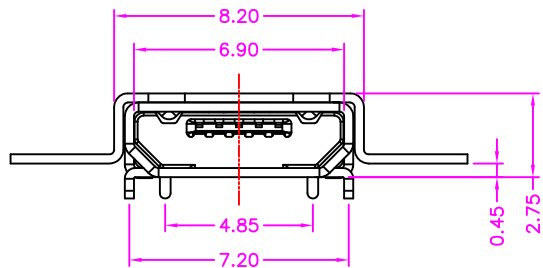

MATERIALS

HOUSING: HI-TEMP. PLASTIC (UL 94V-0), BLACK
SHELL: STAINLESS STEEL
TERMINAL: COPPER ALLOY, GOLD PLATING

SPECIFICATION

CURRENT RATING: 1.8 AMP MAX (ONLY PIN 1, 5), OTHER 1 AMP MAX
DIELECTRIC WITHSTANDING: 100V AC FOR ONE MINUTE
CONTACT RESISTANCE: 30m OHMS MAX
INSULATION RESISTANCE: 100M OHMS MIN AT DC 500V
OPERATION TEMPERATURE: -20°C~+105°C