

P.C.B LAYOUT
TOP VIEW ±0.05

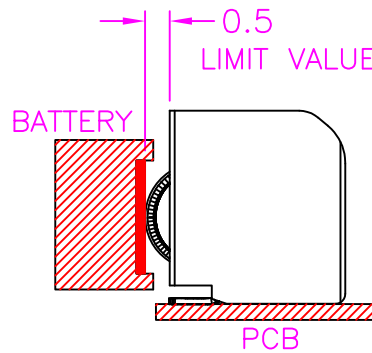
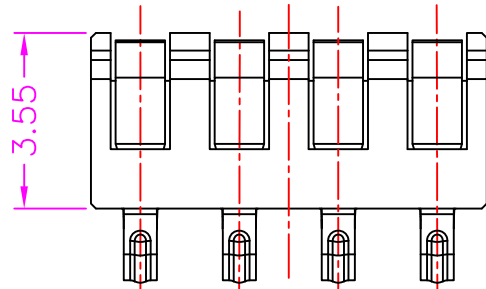

MATERIALS

HOUSING: HI-TEMP. PLASTIC (UL 94V-0), BLACK
TERMINAL: COPPER ALLOY, GOLD PLATED

SPECIFICATION

CURRENT RATING: 2 AMP MAX
DIELECTRIC WITHSTANDING: 500V AC FOR ONE MINUTE
CONTACT RESISTANCE: 30m OHMS MAX
INSULATION RESISTANCE: 500M OHMS MIN AT DC 500V
OPERATION TEMPERATURE: -40°C~+85°C

PART NUMBER:
ABTJU - 0 4 * - 1 2 1

SERIES ——— NO. OF POS. ——— TAPE REEL PACKAGE

CONTACT PLATED OPTION ———

1: GOLD FLASH
3: 3u" GOLD
5: 5u" GOLD
6: 10u" GOLD
7: 15u" GOLD
9: 30u" GOLD



TOLERANCES	
X.±0.40	.XX±0.20
.X±0.30	.XXX±0.10

REV.	A	DRAWN BY	Zhong 2019/5/21	TITLE	BATTERY, 2.00mm PITCH, PCB MOUNT, R/A SMT, FEMALE				
		APPROVED BY	Lion 2019/5/21	DRAW NO.	ABTJU-001	UNIT	MM	Sheet	1/1