

P.C.B. LAYOUT
TOP VIEW ±0.05

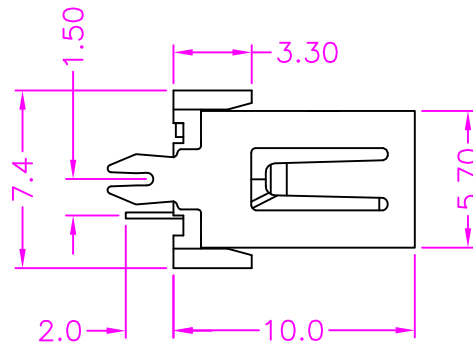

MATERIALS

HOUSING: THERMOPLASTIC (UL 94V-0)
 SHELL: SPCC, NICKEL PLATING
 TERMINAL: COPPER ALLOY, GOLD PLATED ON CONTACT AREA
 TIN PLATING ON SOLDER TAIL

SPECIFICATION

CURRENT RATING: 5 AMP MAX (ONLY 1, 4), OTHER 1.5 AMP MAX
 DIELECTRIC WITHSTANDING: 500V AC FOR ONE MINUTE
 CONTACT RESISTANCE: 30m OHMS MAX
 INSULATION RESISTANCE: 1000M OHMS MIN AT DC 500V
 OPERATION TEMPERATURE: -40°C~+85°C

PART NUMBER:

BUSAA - 0 4 * T - 1 1 C *

SERIES

NO. OF POS.

CONTACT PLATED OPTION

- 1: GOLD FLASH
- 3: 3u" GOLD
- 5: 5u" GOLD
- 6: 10u" GOLD
- 7: 15u" GOLD
- 9: 30u" GOLD

HOUSING COLOR OPTION
 BLANK: BLACK
 W: WHITE

TRAY PACKAGE

TIN PLATING ON SOLDER TAIL