

1/4-36UNS-2A

**MATERIALS**

HOUSING: TEFLON (UL 94V-0), WHITE  
 SHELL: COPPER ALLOY, GOLD PLATING  
 TERMINAL: COPPER ALLOY, GOLD PLATED

**SPECIFICATION**

FREQUENCY RANGE: DC-6 GHz  
 VSWR: 1.50 MAX.  
 OPERATION TEMPERATURE: -40°C~+105°C

**PART NUMBER:**

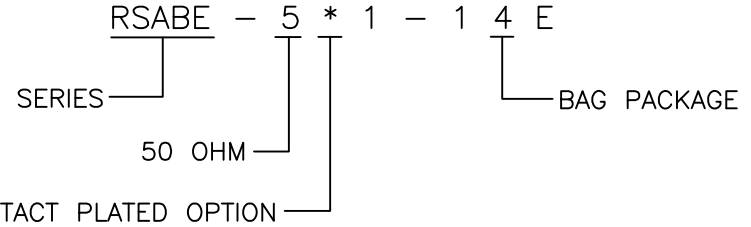

**CONTACT PLATED OPTION**

- 1: GOLD FLASH
- 3: 3u" GOLD
- 5: 5u" GOLD
- 6: 10u" GOLD
- 9: 30u" GOLD

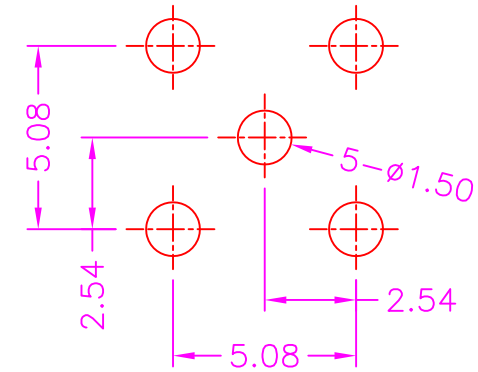
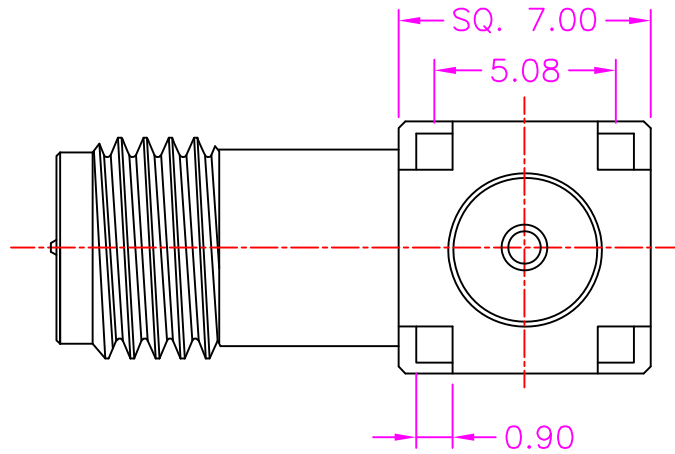

**P.C.B LAYOUT  
 TOP VIEW ±0.05**

REV.	A	DRAWN BY	Zhong 2020/10/28	TITLE	RP SMA, PCB MOUNT, R/A, WITH POST, FEMALE				
		APPROVED BY	Lion 2020/10/28	DRAW NO.	RSABE-014	UNIT	MM	Sheet	1/1