

$A = (\text{NUMBER OF POS.}) \times 0.50 + 4.80$
 $B = (\text{NUMBER OF POS.}) \times 0.50 + 2.10$
 $C = (\text{NUMBER OF POS.}) \times 0.50 + 0.56$
 $D = (\text{NUMBER OF POS.} - 1) \times 0.50$

MATERIALS

HOUSING: HI-TEMP. PLASTIC (UL 94V-0), NATURAL
 ACTUATOR: HI-TEMP. PLASTIC (UL 94V-0), BLACK
 SOLDER PAD: COPPER ALLOY, TIN PLATING
 TERMINAL: COPPER ALLOY

SPECIFICATION

CURRENT RATING: 0.5 AMP MAX
 DIELECTRIC WITHSTANDING: 250V AC FOR ONE MINUTE
 CONTACT RESISTANCE: 30m OHMS MAX
 INSULATION RESISTANCE: 50M OHMS MIN AT DC 250V
 OPERATION TEMPERATURE: -40°C~+85°C

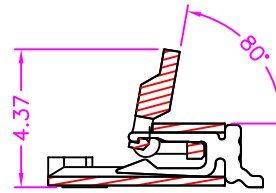
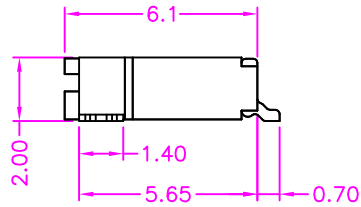
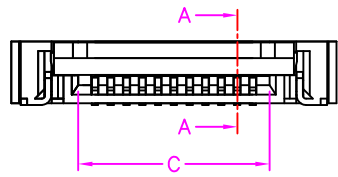

SECTION A-A

PART NUMBER:
 AFPDF - 4 * * * - 1 * G

SERIES: AFPDF
 EASY ON: 4
 NO. OF POS. (10 ~ 68 POS.): * * *
 PACKAGE OPTION: 1: G
 TERMINAL PLATED OPTION:
 1: GOLD FLASH
 3: 3u" GOLD
 5: 5u" GOLD
 6: 10u" GOLD
 7: 15u" GOLD
 9: 30u" GOLD
 T: TIN

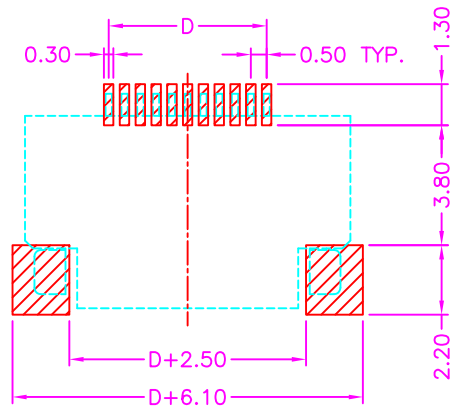

FPC/FFC INSERT DIRECTION

P.C.B LAYOUT
 TOP VIEW ±0.05

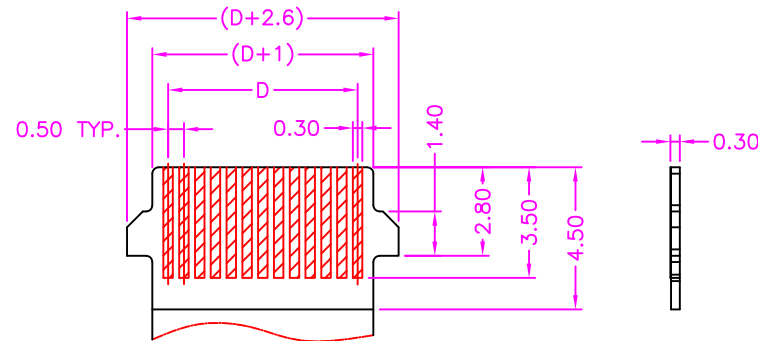

RECOMMENDED FPC/FFC DIMENSION