

A

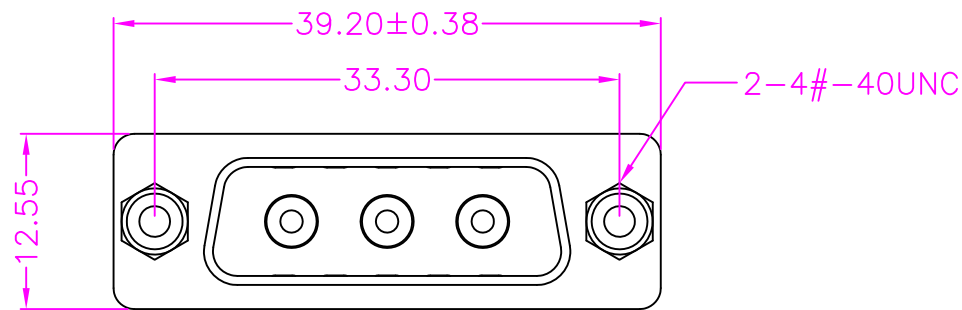

**MATERIALS**

HOUSING: THERMOPLASTIC (UL 94V-0)  
 SHELL: SPCC, NICKEL PLATING  
 BOARDLOCK: SPCC, TIN PLATING  
 SCREW: COPPER ALLOY, NICKEL PLATING  
 TERMINAL: COPPER ALLOY, GOLD PLATED

**SPECIFICATION**

DIELECTRIC WITHSTANDING: 1000V AC FOR ONE MINUTE  
 CONTACT RESISTANCE: 30m OHMS MAX  
 INSULATION RESISTANCE: 1000M OHMS MIN AT DC 500V  
 OPERATION TEMPERATURE: -55°C~+125°C

B

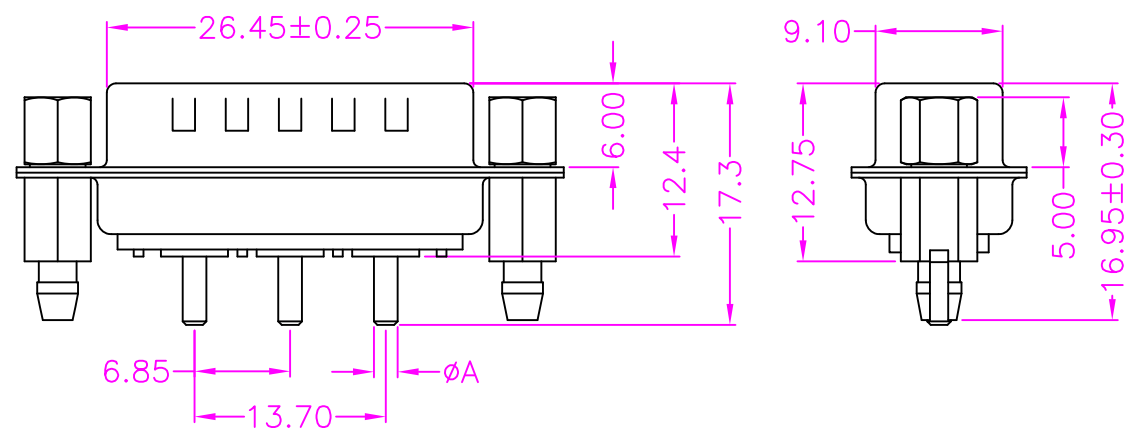

**PART NUMBER:**

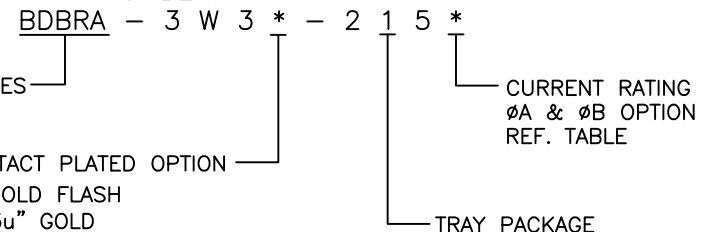

**CONTACT PLATED OPTION**

- 1: GOLD FLASH
- 3: 3u" GOLD
- 5: 5u" GOLD
- 6: 10u" GOLD
- 7: 15u" GOLD
- 9: 30u" GOLD
- 11: 6u" GOLD

C

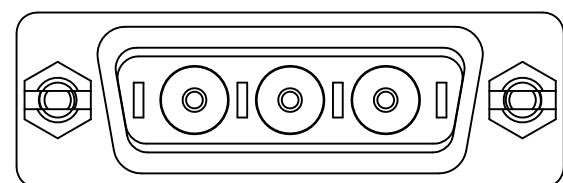

**TABLE**

| P/N | AMPERE | $\phi A$ | $\phi B$ |
|-----|--------|----------|----------|
| A   | 10     | 1.80     | 2.00     |
| B   | 20     | 2.80     | 3.00     |
| C   | 30     | 3.30     | 3.50     |
| D   | 40     | 3.80     | 4.00     |

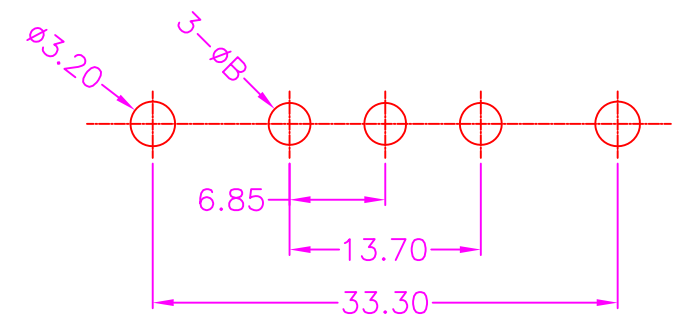

**P.C.B. LAYOUT  
 TOP VIEW ±0.05**

D

**ZICONN**  
 ELECTRONIC CO., LTD.  
 WWW.ZICONN.COM 886-3-4687695

**TOLERANCES**

|         |           |
|---------|-----------|
| X.±0.40 | .XX±0.20  |
| .X±0.30 | .XXX±0.10 |

REV. A

DRAWN BY Zhong 2021/7/7

APPROVED BY Lion 2021/7/7

TITLE

DRAW NO.

COAX. D-SUB, PCB MOUNT, VERTICAL, METAL SHIELD WITH BOARDLOCK  
 MACHINE PIN, 3W3, MALE

BDBRA-005 UNIT MM Sheet 1/1