

MATERIALS

HOUSING: HI-TEMP. PLASTIC (UL 94V-0), BLACK
 SHELL: COPPER ALLOY, GOLD PLATING
 TERMINAL: COPPER ALLOY, GOLD PLATED

INFORMATION

APPLICABLE: AWG #36&40&42&44 (#36 POWER ONLY)
 COMPATIBLE LVDS SOCKET DRAWING NO: BLVDC-003

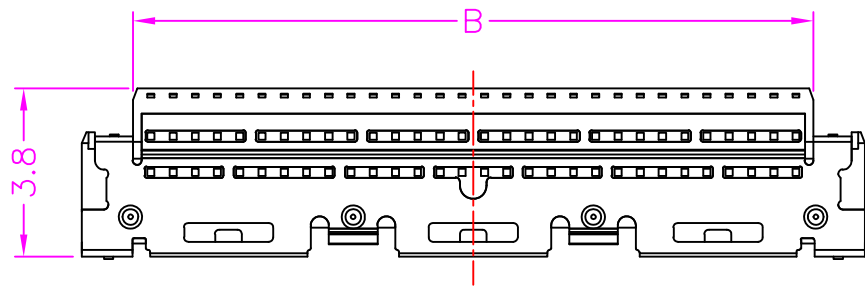
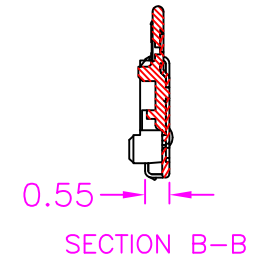
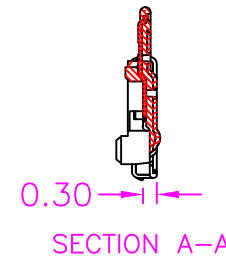
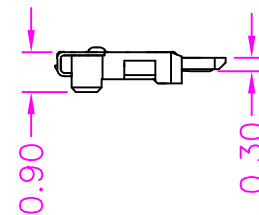
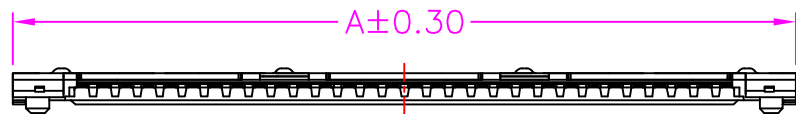

PART NUMBER:

BLVDC - * * * - 2 5 7

SERIES

BOX PACKAGE

NO. OF POS.
REF. TABLE

TERMINAL PLATED OPTION

- 1: GOLD FLASH
- 3: 3u" GOLD
- 5: 5u" GOLD
- 6: 10u" GOLD
- 7: 15u" GOLD
- 9: 30u" GOLD

TABLE

POS	A	B	C
30	17.60	15.30	14.50
40	22.60	22.30	19.50

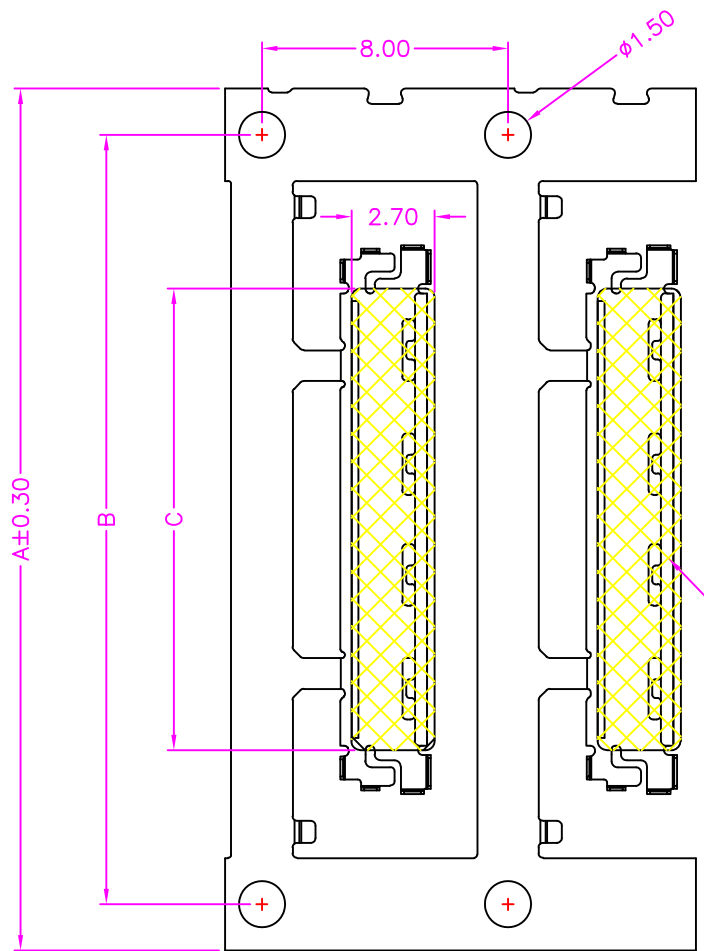

MATERIALS
SHELL: COPPER ALLOY, GOLD PLATING

MYLAR (INSIDE)

GOLD PLATING

TABLE

POS	A	B	C
30	28.00	25.00	15.00
40	33.00	30.00	20.00