

A

B

C

D

A

B

C

D

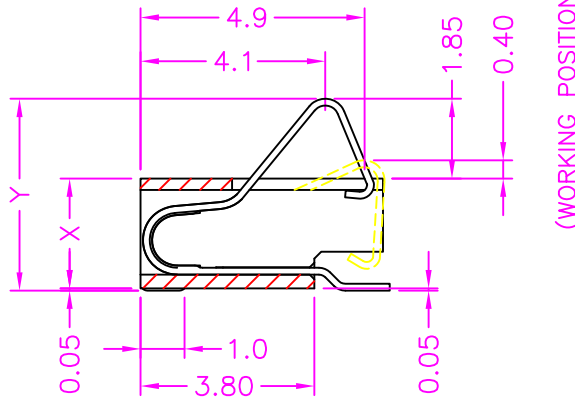
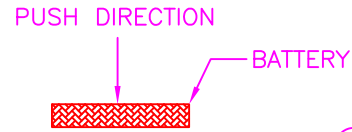
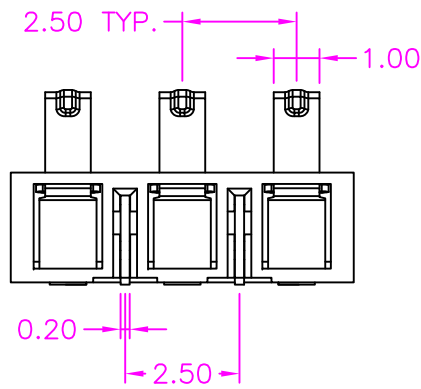
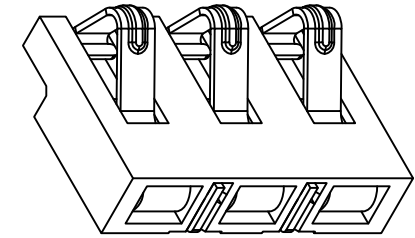
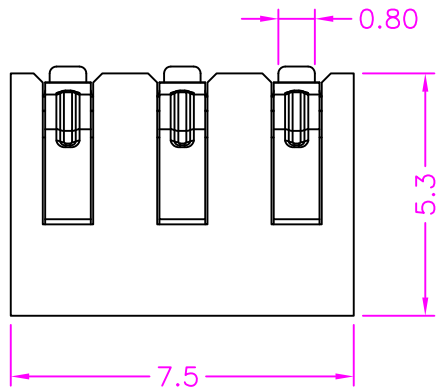

(WORKING POSITION)

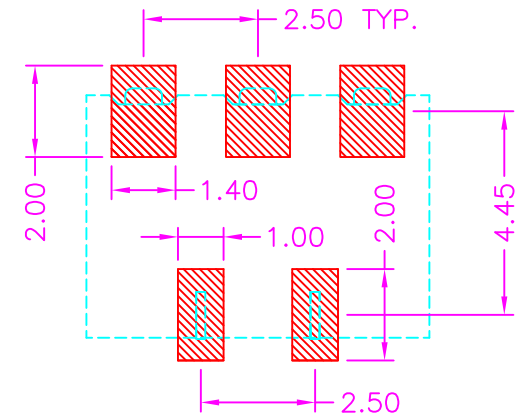

P.C.B. LAYOUT TOP VIEW ±0.05

**MATERIALS**

HOUSING: LCP (UL 94V-0), BLACK  
 PAD: COPPER ALLOY, TIN PLATED  
 TERMINAL: COPPER ALLOY, GOLD PLATED

**SPECIFICATION**

CURRENT RATING: 2 AMP MAX  
 DIELECTRIC WITHSTANDING: 500V AC FOR ONE MINUTE  
 CONTACT RESISTANCE: 50m OHMS MAX  
 INSULATION RESISTANCE: 100M OHMS MIN AT DC 500V  
 OPERATION TEMPERATURE: -40°C~+85°C

**PART NUMBER:**

ABTGH - 0 3 \* - 1 2 5 \*

SERIES  
 NO. OF POS.

HEIGHT OPTION REF. TABLE  
 TAPE REEL PACKAGE

**TERMINAL PLATED OPTION**

- 1: GOLD FLASH
- 3: 3u" GOLD
- 5: 5u" GOLD
- 6: 10u" GOLD
- 7: 15u" GOLD
- 9: 30u" GOLD

**TABLE**

P/N	X	Y
A	2.40	4.30
B	3.00	4.90
C	3.50	5.40



**TOLERANCES**

X.±0.40	.XX±0.20
.X±0.30	.XXX±0.10

REV.	A	DRAWN BY	Mika 2024/1/18	TITLE	BATTERY, 2.50mm PITCH, PCB MOUNT, VERTICAL SMT, WITH PAD, 3PIN
		APPROVED BY	Lion 2024/1/18	DRAW NO.	ABTGH-005

UNIT	MM	Sheet	1/1
------	----	-------	-----