

A

B

C

D

A

B

C

D

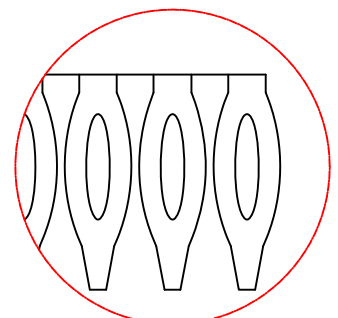
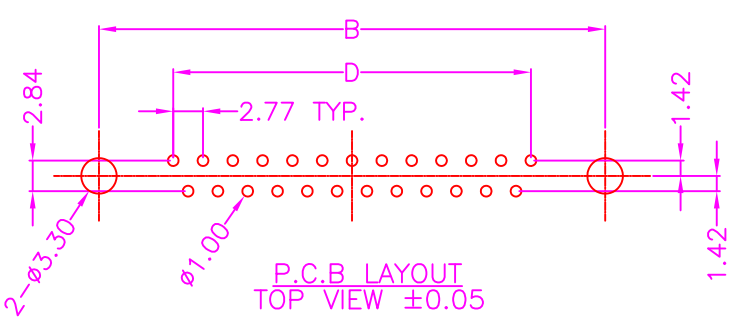
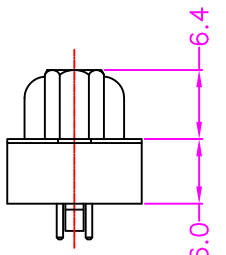
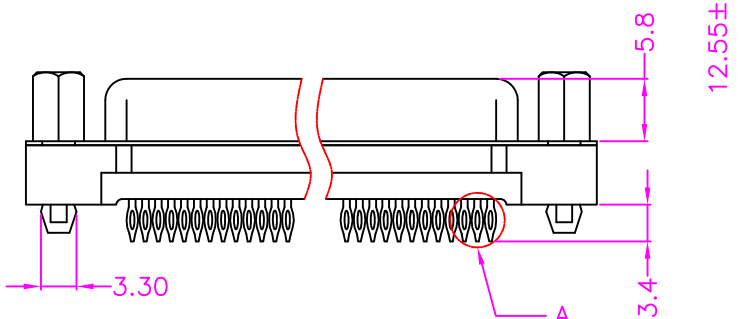
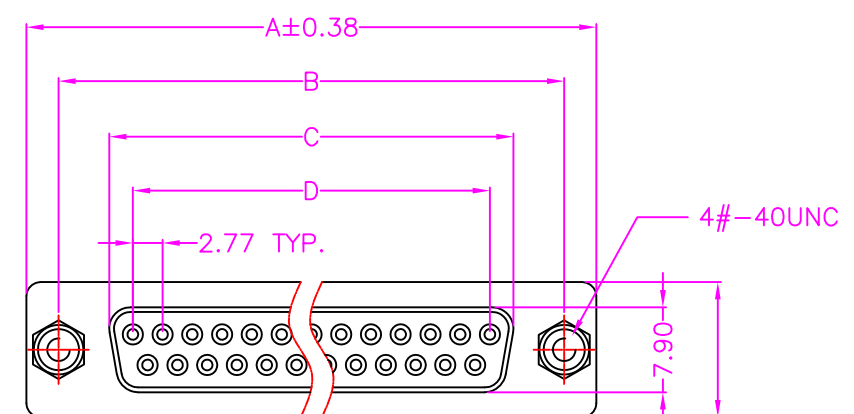

MATERIALS

HOUSING: PBT (UL 94V-0), BLACK
 SHELL: STEEL, TIN PLATING
 BOARDLOCK: COPPER ALLOY, NICKEL PLATING
 SCREW: STEEL, NICKEL PLATING
 TERMINAL: COPPER ALLOY, GOLD PLATED ON CONTACT AREA
 TIN PLATING ON SOLDER TAIL

SPECIFICATION

CURRENT RATING: 3 AMP MAX
 DIELECTRIC WITHSTANDING: 1000V AC FOR ONE MINUTE
 CONTACT RESISTANCE: 30m OHMS MAX
 INSULATION RESISTANCE: 1000M OHMS MIN AT DC 500V
 OPERATION TEMPERATURE: -55°C~+105°C

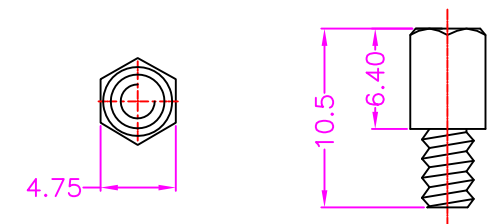
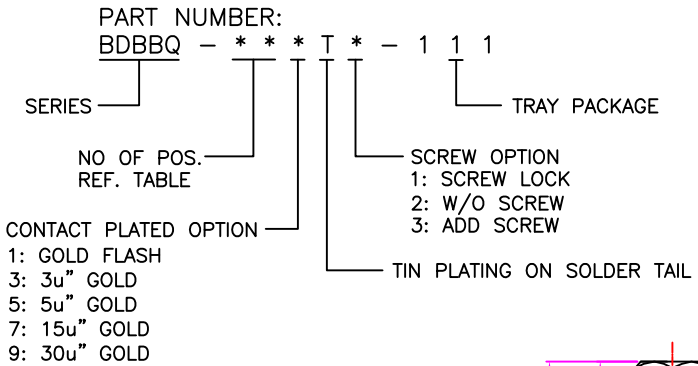

4#-40UNC SCREW

TABLE

POS.	A	B	C	D
09	30.81	24.99	16.33	11.08
15	39.20	33.30	24.70	19.39
25	53.05	47.04	38.40	33.24
37	69.40	63.50	54.80	49.86

ZICONN
 ELECTRONIC CO., LTD.
 WWW.ZICONN.COM 886-3-4687695

TOLERANCES

X.±0.40	.XX±0.20
.X±0.30	.XXX±0.10

REV. A

DRAWN BY **Mika** 2024/3/11

APPROVED BY **Lion** 2024/3/11

TITLE: D-SUB, PCB MOUNT, VERTICAL, METAL SHIELD, PRESS FIT TYPE WITH BOARDLOCK, FEMALE

DRAW NO. BDBBQ-001

UNIT: MM

Sheet 1/1