

P.C.B. LAYOUT
TOP VIEW ±0.05

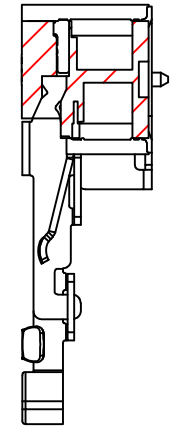

SECTION A-A

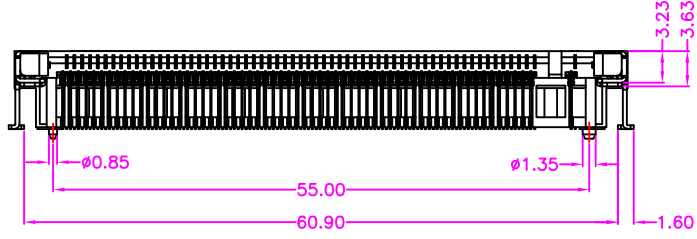
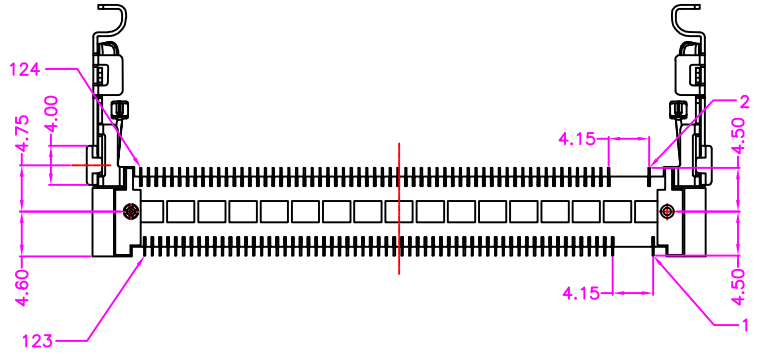

MATERIALS

HOUSING: HI-TEMP. PLASTIC (UL 94V-0), BLACK
LATCH: SUS, TIN PLATING
TERMINAL: COPPER ALLOY, GOLD PLATED

SPECIFICATION

CURRENT RATING: 0.5 AMP MAX
DIELECTRIC WITHSTANDING: 250V AC FOR ONE MINUTE
CONTACT RESISTANCE: 30m OHMS MAX
INSULATION RESISTANCE: 500M OHMS MIN AT DC 500V
OPERATION TEMPERATURE: -55°C~+85°C

PART NUMBER:

MMSLF - 1 2 4 * - 1 1 4

SERIES — NO. OF POS. — CONTACT PLATED OPTION — TRAY PACKAGE

CONTACT PLATED OPTION

- 1: GOLD FLASH
- 2: 2u" GOLD
- 3: 3u" GOLD
- 5: 5u" GOLD
- 6: 10u" GOLD
- 7: 15u" GOLD
- 9: 30u" GOLD



TOLERANCES	
X.±0.40	.XX±0.20
.X±0.30	.XXX±0.10

REV.	A

DRAWN BY	Zhong 2018/5/31
APPROVED BY	Lion 2017/5/31

TITLE	MINI PCI SOCKET 124 PIN, 0.80mm PITCH, PCB MOUNT, SMT, FEMALE WITH LATCH & POST (H=8.00mm)				
DRAW NO.	MMSLF-004	UNIT	MM	Sheet	1/3

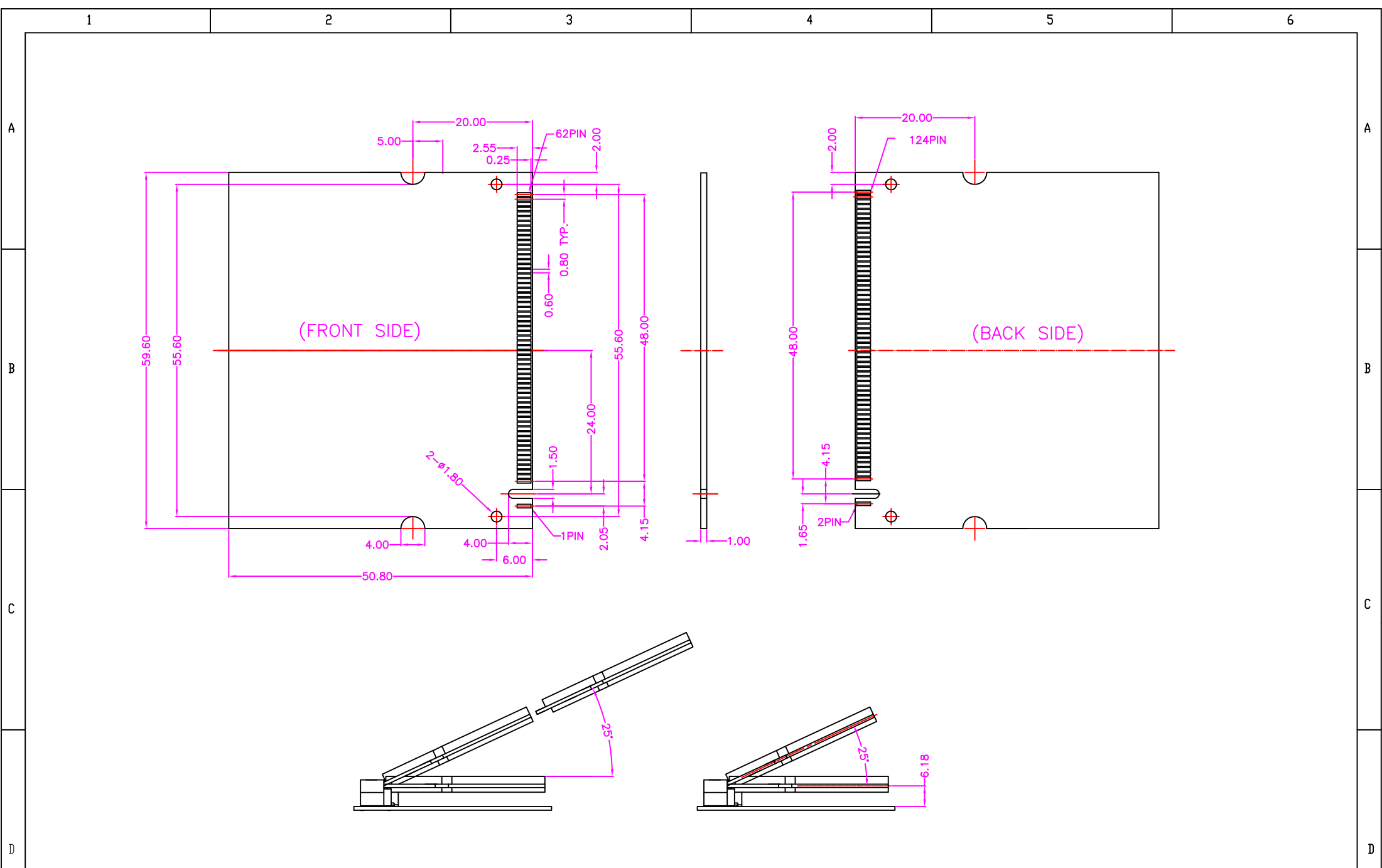

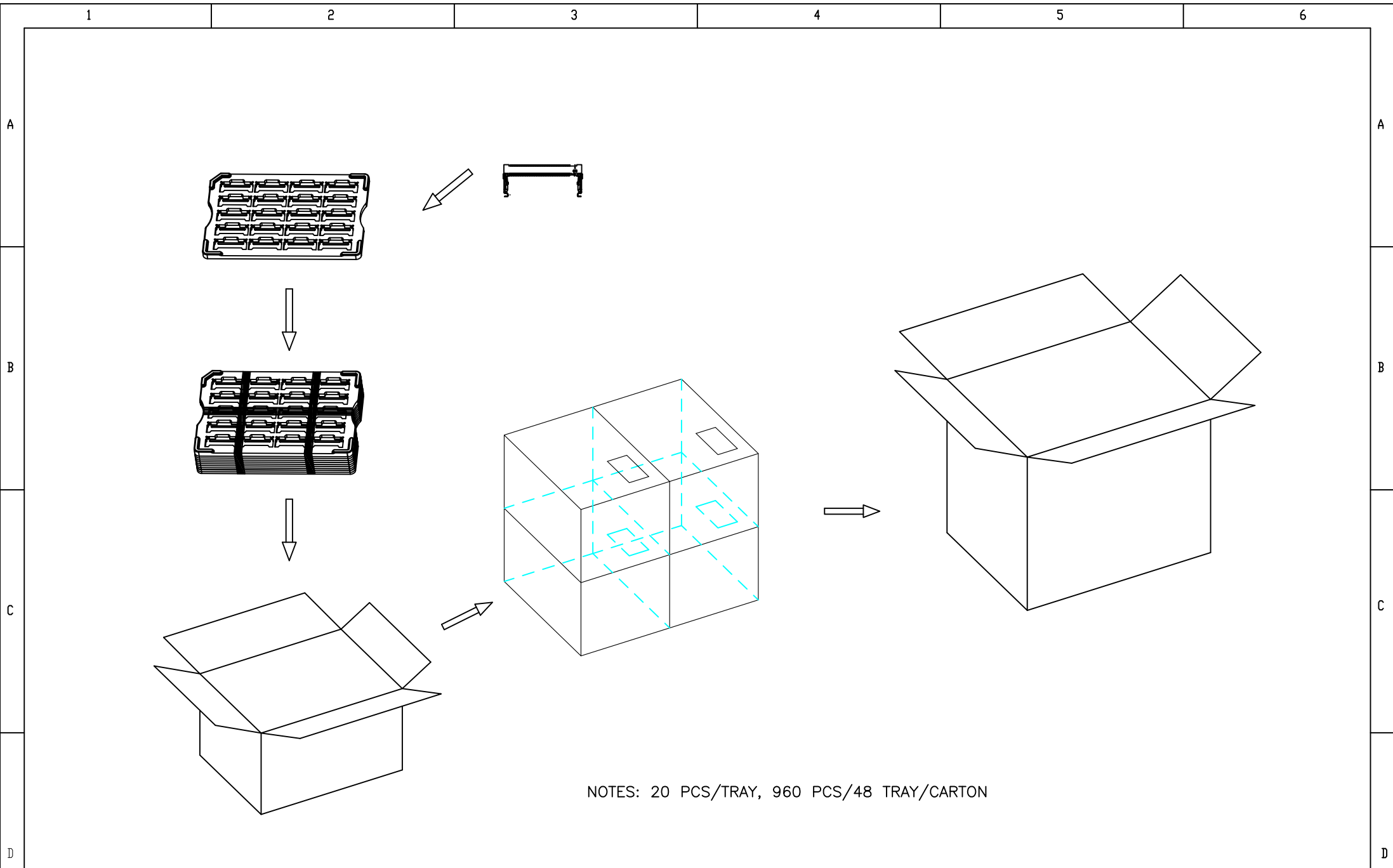

NOTES: 20 PCS/TRAY, 960 PCS/48 TRAY/CARTON